

**AMENDMENT NUMBER ONE
TO PROFESSIONAL SERVICES AGREEMENT
WITH
GILLIS & PANICHAPAN ARCHITECTS, INCORPORATED**

THIS AMENDMENT NUMBER ONE ("Amendment") is made and entered into this 1st day of February, 2022 ("Effective Date"), by and between the CITY OF COSTA MESA, a municipal corporation ("City"), and GILLIS & PANICHAPAN ARCHITECTS, INCORPORATED, a California corporation ("Consultant").

WHEREAS, City and Consultant entered into an agreement dated January 21, 2020 for Consultant to provide professional design services and construction support services in connection with the Costa Mesa Police Department Shooting Range Upgrade Project, now referred to as the Police Department Range Remodel and Upgrades Project (the "Agreement"); and

WHEREAS, City and Consultant desire to amend the Scope of Services to include the additional services identified as Tasks 1 and 2 in Exhibit "A," attached hereto and incorporated herein; and

WHEREAS, City desires to increase Consultant's maximum compensation accordingly to One Hundred Thirty-Eight Thousand Two Hundred Forty-Three Dollars (\$138,243.00).

NOW, THEREFORE, for valuable consideration, the receipt and sufficiency of which is hereby acknowledged, the parties agree as follows:

1. The Scope of Services shall be amended to include the additional services identified as Tasks 1 and 2 in Exhibit A.
2. Section 2.1 of the Agreement shall be amended to reflect that Consultant's total compensation shall not exceed One Hundred Thirty-Eight Thousand Two Hundred Forty-Three Dollars (\$138,243.00).
3. All terms not defined herein shall have the same meaning and use as set forth in the Agreement.
4. All other terms, conditions, and provisions of the Agreement not in conflict with this Amendment shall remain in full force and effect.
5. This Amendment may be executed in one or more counterparts, each of which shall be deemed an original. All counterparts shall be construed together and shall constitute one agreement.

[Signature page follows.]

IN WITNESS WHEREOF, the parties hereto have caused this Amendment to be executed by and through their respective authorized officers, as of the date first written above.

CITY OF COSTA MESA

City Manager

Date: _____

CONSULTANT

Longkavach Panichapan
President/CEO

Date: _____

ATTEST:

City Clerk

APPROVED AS TO FORM:

City Attorney

Date: _____

APPROVED AS TO INSURANCE:

Risk Management

Date: _____

APPROVED AS TO CONTENT:

Project Manager

Date: _____

DEPARTMENTAL APPROVAL:

Public Services Director

Date: _____

APPROVED AS TO PURCHASING:

Finance Director

Date: _____

EXHIBIT A
ADDITIONAL SERVICES



October 19, 2021

Seung Yang, P.E.
City Engineer
City of Costa Mesa
77 Fair Dr. Costa Mesa CA 92626

Subject: ***City of Costa Mesa Police Firing Range: Change Order Requests for ADA and Construction Administration Support Services***

Dear Seung,

We are seeking a change order request for additional work we had provided for this project, as well as additional work we anticipate to provide due to the expanded scope of work to cover ADA retrofits and accessibility improvements for the facility to accommodate the original scope of the Firing Range at the Police Station.

A. SCOPE OF WORK SUMMARY

The requested change orders for this project are based on the following three (3) tasks that provide additions and alterations to the original scope of work:

1. **ADA Assessment Report:** (Originally submitted 3/4/21) Provide Accessibility/ ADA Assessment Report on the the facility based as it relates to the primary proposed renovation for the Firing Range. Report illustrating existing conditions that would need upgrades and retrofits (Exhibit A)
2. **A&E services for ADA retrofits:** (Originally submitted 5/26/21) Provide A&E services to develop construction documents through construction support for selected ADA retrofits outlined in the Accessibility/ ADA report. (Exhibit B)
3. **Supplemental Construction Administration*:** (New) Construction Support Services for the expanded scope of work. (Exhibit C) *

*Regarding third task #3, we are requesting this change order for additional Construction Administration services work due partially to the expanded scope of work provided over the course of the project up to this time.

During the course of the project, there were not enough funds to cover the accessibility coordination within the existing scope. These additional services provided needed to be allocated from funds originally dedicated to future phases of the project (Including the original Construction Administration Phase) to develop solutions and conceptual schemes to address the Accessibility constraints and obstructions of the existing facility above and beyond original scope of the Firing Range. It included coordination with City Building Department and Plan check to determine the final scope and extent of the ADA retrofits.



B. **COMPENSATION**

The following are the proposed fees for each respective tasks followed by a grand total not to exceed:

1. **ADA Assessment Report**
\$2,933 (Two Thousand Nine Hundred and Thirty-Three Dollars)
2. **A&E services for ADA retrofits:**
\$35,480 (Thirty-Five Thousand Four Hundred and Eighty Dollars)
3. **Supplemental Construction Administration:**
\$32,000 (Thirty-two Thousand Dollars)

GRAND TOTAL FOR ALL 3 TASKS: \$70,413
(Seventy Thousand, Four Hundred and thirteen dollars)

Refer to attached Exhibits A, B, and C for additional details about each respective task.

Additional services outside the Scope of Work agreed upon shall not be performed without the authorization of the City. We have tailored our scope and subsequent fee proposal to accommodate the scope of work, realizing that there is latitude in both parameters to be discussed during the contract negotiation.

Sincerely,

Jack Panichapan, AIA, LEED AP, President, CEO
Gillis + Panichapan Architects, Inc.

EXHIBIT A: ADA ASSESSMENT REPORT



March 4, 2021

Seung Yang, P.E.
City Engineer
City of Costa Mesa
77 Fair Dr. Costa Mesa CA 92626

Subject: ***City of Costa Mesa Police Firing Range: ADA Report and Assessments***

Dear Seung,

The following work outlined is in response to potential ADA accessible code requirements by the City of Costa Mesa triggered by the proposed renovations for the new Firing Range located at the City's Police Headquarters at 99 Fair Drive. Based on building code requirements, the proposed renovation would require additional building and site improvements/ verification to meet current code requirements for accessibility per section 11B-202.1 of the CBC.

We will be coordinating with the Accessibility consultant to determine the potential of retrofits required by code, and help the City determine an accessibility retrofit scope for this project to fulfill Plan Check requirements for ADA accessibility.

A. SCOPE OF WORK SUMMARY

- Provide Report illustrating existing conditions that would need accessible code upgrades (see attached consultant proposal).

B. CONSULTANTS

We will plan to utilize the following consultants:

Accessibility Consultant
Casper Development Resources, Inc
5360 Jackson Drive, Suite 114 La Mesa, Ca 91942
619.741.1080

(Please refer to attached consultant proposal)

C. COMPENSATION

We propose to furnish these services not to exceed:

\$2,550 (Two Thousand Five Hundred and Fifty Dollars) includes potential consultant reimbursable and expenses
+ 15% administrative coordination (\$383)

\$2,933 (Two Thousand Nine Hundred and Thirty-Three Dollars)

Please see attached consultant proposal. Additional services outside the Scope of Work agreed upon shall not be performed without the authorization of the City. We have tailored our scope and subsequent fee proposal to accommodate the scope of work, realizing that there is latitude in both parameters to be discussed during the contract negotiation.



Sincerely,

A handwritten signature in black ink, appearing to read 'JP', is written over the signature line.

Jack Panichapan, AIA, LEED AP, President, CEO
Gillis + Panichapan Architects, Inc.

EXHIBIT A - DESCRIPTION OF SERVICES**A. SERVICES****A.1 SITE EVALUATION SURVEY**

Consultant shall conduct a Facility Inspection ("Inspection") of the facility(s) listed in Exhibit "A-1" (the "Facility"). The portion of each facility included in the Inspection is limited to those areas identified in "Exhibit A-1" and as further limited by the following.

The Inspection shall, unless otherwise excepted herein, compare elements with: (i) the current new building construction requirements of the Americans with Disabilities Act Accessibility Standards (the "ADAS") and (ii) the current new building provisions of the California Building Code that exclusively and unambiguously address disabled access issues (the "CBC").

Consultant shall only examine those features that are: (1) required to be evaluated hereunder and (2) specifically and unambiguously required to be accessible pursuant to the ADAS and CBC as Consultant understands these obligations.

Consultant shall not be responsible for any analysis in connection with fire alarms or any other alarm system or the operating condition of any telephones, assistive listening system or any other electronic device of any nature whatsoever. Consultant shall not be responsible for examining any feature or facility outside the boundary of a Facility, including without limitation, any feature in any public right-of-way. Consultant shall not be responsible to analyze any policy or procedures.

Though Consultant shall use its reasonable best efforts to locate and evaluate features required to be accessible under the ADAS and CBC, Consultant and Client agree that an occasional and/or immaterial failure to identify and/or evaluate any particular subject feature will not be deemed to be a breach of Consultant's duties hereunder.

A.2 REPORT - (NON-CRASCA)

Consultant shall memorialize the findings of the SES in a written standardized report ("Report").

The report is not intended to conform to the requirements of the Construction-Related Accessibility Standards Compliance Act (CRASCA, CA Civil Code 55.51–55.545).

The Report shall identify elements which do not conform to the new construction related ADAS or CBC requirement. Consultant shall include a color digital photograph of each element identified as non-conforming.

In the event that any specific area, feature or item (or portion thereof) does not reflect the relevant requirements of ADAS or CBC/DA, Consultant shall attempt to make a simple and general "recommendation." Each recommendation comes from a standard list or possible recommendations for features similar to the feature being evaluated. The recommendation is derived from a basic cursory examination of each subject feature and

EXHIBIT A: ADA ASSESSMENT REPORT

represents only one possible physical solution to bring the subject feature into comparative compliance with ADAS and CBC/DA New Construction standards.

Consultant shall deliver one electronic copy of each Report to Client in Adobe PDF format.

B. EXCLUSIONS

Consultant shall not be obligated to provide any services other than those set forth in Section A.1 and A.2, above, including, without limitation, the following:

- a. Services related to the portions of the ADA dealing with employment policies, transportation issues and telecommunications.
- b. Analysis of the requirement of Section 504 of the Rehabilitation Act of 1973.
- c. Analysis of concealed or unknown conditions or characteristics of any facility or performance of destructive testing of any sort or nature.
- d. Analysis of survey of any facility's compliance with applicable codes and standards (excluding Disabled Access Laws) including, but not limited to building, health, zoning, seismic and life safety codes.
- e. Design or construction work of any nature whatsoever.
- f. Any research or analysis of the permit history or construction dates of any building or facility.

C. CLIENT DUTIES REGARDING SITE EVALUATION

Client shall provide the following:

- a) Client shall provide Consultant with the right to enter from time to time, property owned by the Client and/or others so Consultant may perform the Services.

D. SCHEDULE

Consultant shall perform the services outlined in A.1 & A.2 (Inspection and Report) within thirty (30) days of receiving a fully executed contract.

Consultant shall perform the services outlined in A.3 (Review of Phasing Schedule) within fourteen (14) days of receiving the schedule from Client.

E. MISCELLANEOUS

All services shall be performed by a minimum of one of the following persons:

Neal Casper
CAsp-020
Expiration 9/29/2020

EXHIBIT "B" - FEE FOR SERVICES

Consultant and Client agree that Consultant shall charge a fee (the "Fee") of **\$2,400.00** or the provision of Services set forth in Sections A.1, A.2 and A.3 of Exhibit "A".

Travel Expenses (estimated at \$105.00)

If Consultant utilizes their automobiles in the provision of services, mileage shall be charged at the published IRS mileage rate (currently \$0.56 per mile).

Miscellaneous

Client understands and affirms that this Agreement is between Client and Consultant only and payment to Consultant by Client is not dependent upon Client's reimbursement of Consultant's fees, costs and expenses by any third parties whatsoever.

Unless otherwise agreed in writing, all fees and costs shall be due and payable within thirty (30) days of the date upon which they are invoiced to Client. Any sums not paid when due and payable shall accrue interest at a rate of 15% per annum until paid in full.

ADDITIONAL SERVICES

Additional services, should they be requested, including consulting time connected with Consultant's finding, shall be billed in accordance with Exhibit C - Standard Rates.

EXHIBIT “C” - STANDARD RATES**Principal Consultant/Expert Rates**

Document or Plan Review (2hr minimum):	\$250 per hour
Research, Investigation or Consulting (4hr minimum):	\$250 per hour
Deposition or Sworn Testimony:	\$375 per hour

Associate or Administrative Rates

Document or Plan Review (Associate):	\$150 per hour
Research, Investigation or Consulting (Associate):	\$150 per hour
Technical / Clerical or Administrative:	\$100 per hour

Consultant's hourly rates shall be billed in ¼ hour increments.

Travel Time

Consultant shall be entitled to compensation for Travel Time while away from his office. Travel Time will be charged to Client at Consultant's regular hourly rate from the time of departure from Consultant's office until the time of return (portal to portal).

Expenses – Travel-Related & Other

Client shall reimburse Consultant for all reasonable costs (including, without limitation, photocopying, parking, travel expenses, overnight delivery charges, messenger service and printing) in an amount equal to said costs plus a markup of 10%.

Travel Expenses include, but are not limited to:

- | | |
|---------------|--|
| 1. Parking | Garages, tolls & airport |
| 2. Airfare | Flights 0-2 hours - Refundable Coach |
| | Flights 2-4 hours – Refundable Coach Plus & Wifi |
| | Flights 4+ hours – First Class & Wifi |
| | (Time based on total duration for day's flight(s)) |
| 3. Hotel | Business class |
| 4. Meals | Breakfast / Lunch / Dinner |
| 5. Car Rental | Intermediate class |

Expenses – Use of Personal Vehicles

In the event that Consultant or staff utilizes their automobiles in connection with the provision of Services, mileage shall be charged at the standard mileage rate published by the IRS from time to time (currently \$0.56 per mile).

Terms

Unless otherwise agreed in writing, all fees and costs shall be due and payable within thirty (30) days of the date upon which they are invoiced to Client. Any sums not paid when due and payable shall accrue interest at a rate of 15% per annum until paid in full.

Client understands and affirms that this Agreement is between Client and Consultant only and payment to Consultant by Client is not dependent upon Client's reimbursement of Consultant's fees, costs and expenses by any third parties whatsoever.

EXHIBIT A-1 – FACILITIES

Costa Mesa Police Facility
99 Fair Drive
Costa Mesa, CA

Inspection limited to the path of travel serving the basement shooting range as marked on the attached plans (dotted red line) including:

1. Accessible parking near the building entrance
2. Accessible route between city sidewalk, accessible parking and the facility entrance
3. Route from facility entrance to the basement (elevator / stairs / hallways)
4. Basement toilet and shower rooms

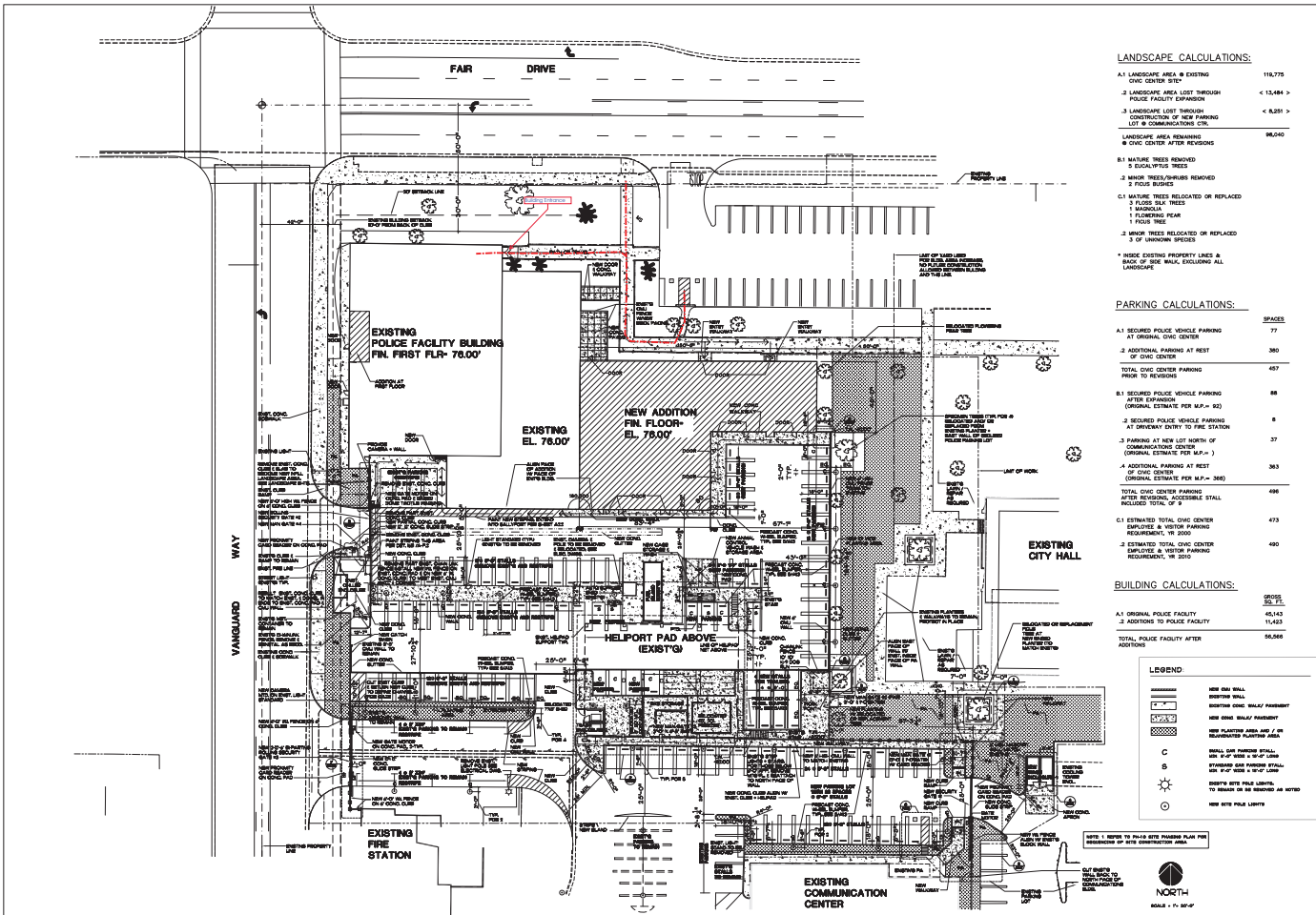

APPROVED BY

COSTA MESA POLICE FACILITY Expansion & Renovation

City of Costa Mesa
30 Fair Drive
Costa Mesa, CA 92626

DRAWN BY: 310.03
CHECKED BY:
DATE:
SHEET TITLE: SITE PLAN
SHEET: A1.1
OF SHEETS:

EXHIBIT A: ADA ASSESSMENT REPORT

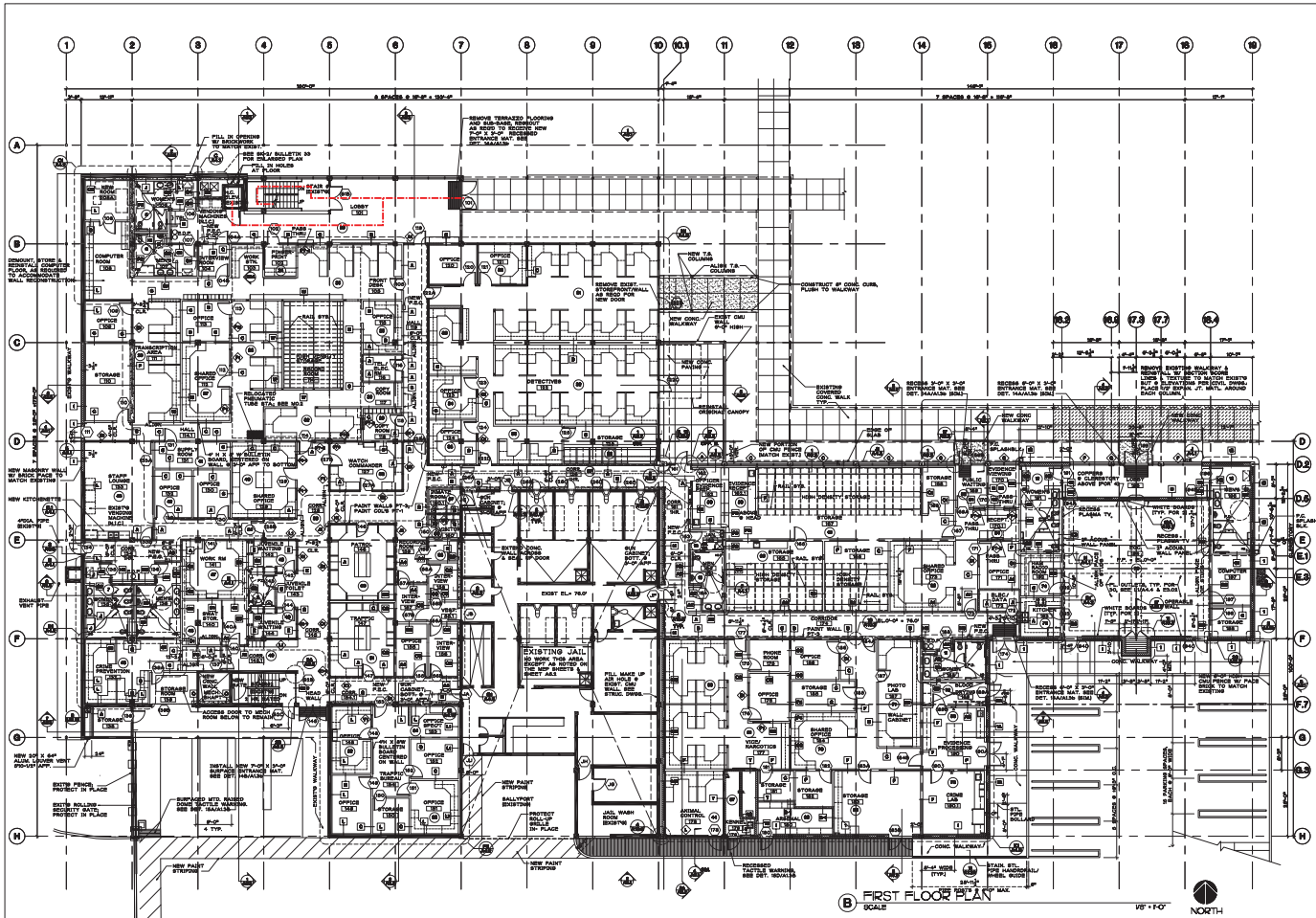

These drawings are instruments of service and are the property of Meyer & Allen Associates. All design and other information on the drawings are for use on the specified project and shall not be used without expressed written permission of Meyer & Allen Associates.

Copyright, 1999, Meyer & Allen Associates.
All Rights Reserved.

APPROVED BY

[illegible]

**COSTA MESA
POLICE FACILITY**
Expansion & Renovation
City of Costa Mesa
99 Fair Drive
Costa Mesa, CA 92628

DRAWN BY: HN	310.03
CHECKED BY: HT	
DATE:	
SHEET TITLE	

FIRST FLOOR PLAN

SHEET
A2.2
OF SHEETS

EXHIBIT A: ADA ASSESSMENT REPORT

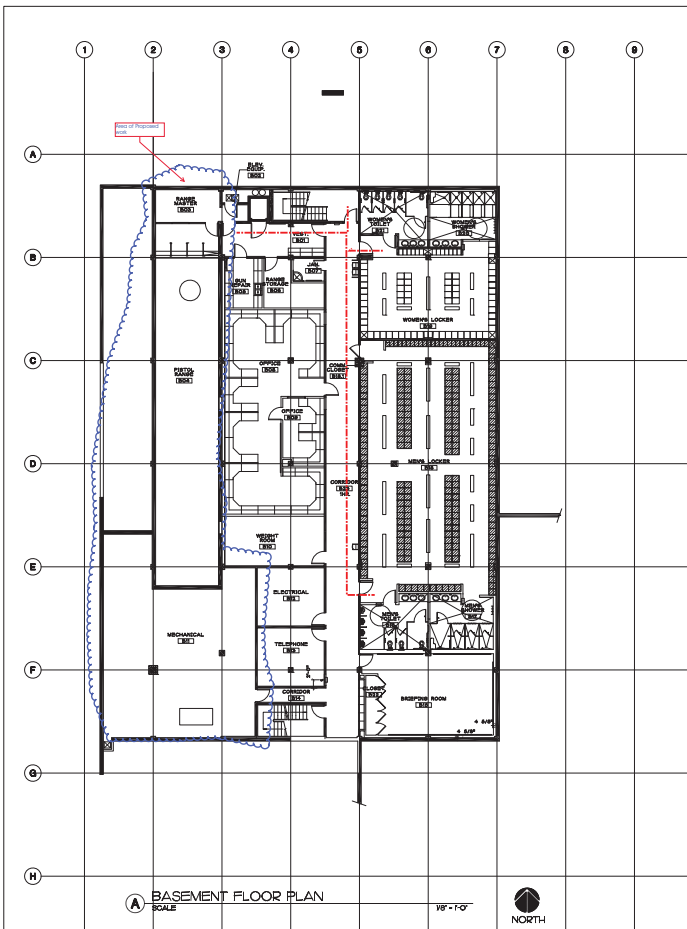

GENERAL NOTES:	SYMBOLS LEGEND:	WALL TYPES LEGEND:
1. TOP OF FLOOR SLAB - E.L. = 5'-0" (SEE BL. - 000 - REVISIONS SHEET PAGE 2)	① INTERIOR EXTERIOR, SEE SHEETS A-1 THRU A-7	===== EXISTING WALL/COLUMN
2. ALL INTERIOR STUCCO PARTITIONS TO BE 5/8" THICK CONCRETE BLOCK	② DOOR MARKER, SEE SHEET A-1	===== NEW W.P. 0.0
3. EXTERIOR STUCCO IS "TYPICAL" EXTERIOR STUCCO, SEE SCHEDULE EXTERIOR STUCCO, 1000	③ WINDOW TYPE, SEE SHEET A-3	===== NEW CMU WALL
4. FOUNDATIONS ARE SHOWN TO PERM. CENTER OF GRAVITY OF WALL. IN SECTION OF WALL, FOUNDATION IS SHOWN TO PERM. CENTER OF GRAVITY. IF WALL IS NOT TO BE SHOWN AS FOUNDATION	④ WALL TYPE, SEE SHEET A-5/⑥	===== NEW CONCRETE WALL
5. FOUNDATIONS ARE TO BE PERM. CENTER OF GRAVITY OF WALL. IN SECTION OF WALL, FOUNDATION IS SHOWN TO PERM. CENTER OF GRAVITY. IF WALL IS NOT TO BE SHOWN AS FOUNDATION		===== W. PR. RATED WALL
6. DOORS OR WINDOWS SETTED AS "STANDARD" UNLESS NOTED OTHERWISE. SEE SCHEDULE DOORS AND WINDOWS, 1000. ALL PARTS WERE CHECKED IN THESE ROOMS.		

[illegible]

NOTE:
1. ALL ITEMS ARE BY BOBROCK,
UNLESS OTHERWISE NOTED.
2. PROVIDE MIN. 948A. BACKING IN
STUD WALLS AT ALL ACCESSORY
LOCATIONS.

[illegible]

These drawings are instruments of service and are the property of Meyer & Allen Associates. All designs and other information on the drawings are for use on the specified project and shall not be used without expressed written permission of Meyer & Allen Associates.

Copyright 1999, Meyer & Allen Associates.

APPROVED BY _____



M-E ENGINEERS, INC.
CONSULTING ENGINEERS
18113 JEFFERSON BOULEVARD
DALLAS CITY, CA 95222
tel (312) 842-5790
fax (312) 842-7790

[illegible]

**COSTA MESA
POLICE FACILITY**
Expansion & Renovation

City of Costa Mesa
99 Fair Drive
Costa Mesa, CA 92628

DRAWN BY:	310.03
CHECKED BY:	
DATE:	
SHEET TITLE	

**BASEMENT
FLOOR PLAN**

SHEET
A2.1
OF SHEETS

EXHIBIT B: A&E SERVICES FOR ADA RETROFITS



May 26, 2021

Seung Yang, P.E.
City Engineer
City of Costa Mesa
77 Fair Dr. Costa Mesa CA 92626

Subject: **City of Costa Mesa Police Firing Range: A&E Services for ADA Improvements**

Dear Seung,

The following proposal is for providing A&E services to the selected retrofits from the ADA report that has been completed in response to the proposed renovations for the new Firing Range located at the City's Police Headquarters at 99 Fair Drive.

We understand that this project would involve an architectural, structural, and mechanical engineering scope of design improvements, planning review/ entitlement, design development, and construction support for these additional accessibility retrofits.

This proposal includes the following:

- Detailed Cost Proposal for A&E Services
- Statement of Probable Construction Costs based on respective itemized ADA Retrofits (For reference)

B. COMPENSATION

We propose to furnish these services not to exceed:

\$35,480 (Thirty-Five Thousand Four Hundred and Eighty Dollars)

Additional services outside the Scope of Work agreed upon shall not be performed without the authorization of the City. We have tailored our scope and subsequent fee proposal to accommodate the scope of work, realizing that there is latitude in both parameters to be discussed during the contract negotiation.

Sincerely,

A handwritten signature in black ink, appearing to read 'JP' or similar initials, followed by a flourish.

Jack Panichapan, AIA, LEED AP, President, CEO
Gillis + Panichapan Architects, Inc.

EXHIBIT B: A&E SERVICES FOR ADA RETROFITS

City of Costa Mesa

Costa Mesa P.D. - Shooting Range Upgrade (ADA)

OPTION 1 - Summary

Statement of Probable Cost

DRAFT

Date: 05/24/2021

Element	Quantity	Unit	Unit Cost	Total
01 General Conditions (incl. below)				
02 Parking/Site (exterior):				\$3,500.00
03 Building (interior):				\$8,300.00
04 Elevator:				\$60,500.00
05 Stairs:				\$11,400.00
06 Women's Lockers/Toilet				\$58,050.00
07 Men's Lockers/Toilet				\$65,925.00
Subtotal				\$207,675
Subtotal				\$207,675
General Conditions		10.0%		\$20,768
Subtotal				\$228,443
Overhead & Profit		10.0%		\$22,844
Subtotal				\$251,287
Bonds & Insurance		2.5%		\$6,282.17
Subtotal				\$257,569
Design Contingency		10%		\$25,757
Subtotal				\$283,326
Construction Contingency		10%		\$28,333
TOTAL ESTIMATE				\$311,658

EXHIBIT B: A&E SERVICES FOR ADA RETROFITS

City of Costa Mesa
 Costa Mesa P.D. - Shooting Range Upgrade (ADA)
 Statement of Probable Cost
 Date: 05/24/2021

Detail

DRAFT

Element	Quantity	Unit	Unit Cost	Total
01 General Conditions (Incl. below)				
02 Parking/Site (exterior):				
New/Replaced Parking signage (Driveway entrance)	1	LS	\$300.00	\$300.00
New accessible stall paint marking	1	LS	\$1,000.00	\$1,000.00
Grind A.C. and Concrete to be flush at path of travel (1/4" +/-)	1	LS	\$800.00	\$800.00
New accessible stall paint marking (International symbol)	1	LS	\$600.00	\$600.00
New/Replaced Parking signage (Stall identification)	1	LS	\$800.00	\$800.00
Sub-total				<u>\$3,500.00</u>
03 Building (interior):				
Replace protruding object in path of travel (4" max.)	1	LS	\$600.00	\$600.00
B01 Entrance: Provide Lever type door hardware	1	ea	\$800.00	\$800.00
B01 Entrance: Remove existing kick-down door stop. Provide overhead door stop (if allowed by Wall/Door rating)	1	LS	\$900.00	\$900.00
B01: Entrance: Adjust or replace door closer	1	ea	\$800.00	\$800.00
B01: relocate cabinet to provide 60" clear.	1	LS	\$500.00	\$500.00
B01: relocate Room Signage	1	LS	\$800.00	\$800.00
B03: Door: Remove kick-down door stop. Provide overhead door stop (if allowed by Wall/Door rating)	1	LS	\$900.00	\$900.00
B03: relocate Room Signage	1	LS	\$800.00	\$800.00
Signage: Provide tactile Braille "EXIT" signage.	1	ea	\$250.00	\$250.00
Signage: Stairs: Provide tactile Braille signage "EXIT STAIR DOWN,UP".	1	ea	\$250.00	\$250.00
Signage: Provide tactile Braille "EXIT ROUTE" signage (Stair 1 and at room B01)	2	ea	\$250.00	\$500.00
Drinking Fountain: Basement: relocate adjacent railings	1	LS	\$1,200.00	\$1,200.00
Sub-total				<u>\$0.00</u> <u>\$8,300.00</u>
04 Elevator:				
Call Buttons: replace or provide additional buttons at wall (lighted/ registered)	2	ea	\$1,500.00	\$3,000.00
Call Signal: provide lighted signal (wall mounted -high)	2	ea	\$1,500.00	\$3,000.00
Signage: Braille floor level signs (each floor)	2	ea	\$250.00	\$500.00
Elevator doors: install auto-operators for doors.	2	ea	\$20,000.00	\$40,000.00
Elevator Car: Options for elevator finishes/materials for options to widen cab.	1	LS	\$4,000.00	\$4,000.00
Elevator Car control buttons: Replace as required to comply	1	LS	\$8,000.00	\$8,000.00
Elevator Limited Type certification	1	LS	\$2,000.00	\$2,000.00
Sub-total				<u>\$60,500.00</u>
05 Stairs:				
Provide signage (Braille floor level) at each floor level landing/door	2	ea	\$250.00	\$500.00

EXHIBIT B: A&E SERVICES FOR ADA RETROFITS

City of Costa Mesa

Costa Mesa P.D. - Shooting Range Upgrade (ADA)

Statement of Probable Cost

Date: 05/24/2021

Detail

DRAFT

Element	Quantity	Unit	Unit Cost	Total
Provide/replace outside handrail at middle landings.	60	LF	\$165.00	\$9,900.00
Provide guard rail at underside of Stairs	1	ea	\$1,000.00	\$1,000.00
Sub-total				<u>\$11,400.00</u>

06 Women's Lockers/Toilet

Signage: Replace braille signage at wall. Relocate sign at door	1	ea	\$250.00	\$250.00
B19: Remove kick-down hold open	1	ea	\$300.00	\$300.00
B19: Adjust or replace door closer	1	ea	\$900.00	\$900.00
B19: Door clearance: provide and install low energy door operatc	1	ea	\$16,000.00	\$16,000.00
B19: Remove or relocate protrusion at wall or provide detectable barrier below item	1	ea	\$900.00	\$900.00
Signage: relocate room signage	1	ea	\$800.00	\$800.00
B20: Install ADA Circle symbol on door	1	ea	\$250.00	\$250.00
B20: Remove kick-down hold open	1	ea	\$300.00	\$300.00
B20: Adjust or replace door closer	1	ea	\$900.00	\$900.00
Accessible toilet partition: replace partition door hardware with self-closing device	1	LS	\$3,000.00	\$3,000.00
Accessible toilet stall clearance: replace adjacent sink to provide 60" clear	1	LS	\$8,000.00	\$8,000.00
Accessible toilet stall clearance: reconfigure stall door providing 4" max. jamb	1	ea	\$1,000.00	\$1,000.00
Accessible toilet stall door: install additional door pull 34" to 44" high	1	ea	\$1,000.00	\$1,000.00
Accessible toilet stall: relocate/adjust grab bars	1	LS	\$1,500.00	\$1,500.00
Accessible toilet stall: install/relocate toilet tissue dispenser rolls	1	LS	\$1,500.00	\$1,500.00
Accessible toilet stall: install/relocate toilet seat cover dispenser rolls	1	LS	\$1,500.00	\$1,500.00
Accessible toilet stall: install/relocate disposal unit	1	LS	\$1,500.00	\$1,500.00
B21: Door signage: Install ADA Circle symbol on door	1	ea	\$250.00	\$250.00
B21: Shower stall: replace diverter controls and relocated Water valve controls and Hand held spray unit	1	LS	\$6,000.00	\$6,000.00
B21: Shower stall: cut back plastic partition	1	LS	\$800.00	\$800.00
B21: Shower stall: replace floor tile and provide max. slope of 2.08%	1	LS	\$8,000.00	\$8,000.00
B21: Threshold: replace door threshold	1	ea	\$500.00	\$500.00
B21: Floor Drain. Retile floor and reset floor drain	1	LS	\$2,000.00	\$2,000.00
B21: Sink drains: provide insulated pipes	1	ea	\$250.00	\$250.00
Sink, Label Accessible sink in one room	1	ea	\$250.00	\$250.00
B21: Sink, Replace soap dispenser	1	ea	\$400.00	\$400.00
Sub-total				<u>\$58,050.00</u>

EXHIBIT B: A&E SERVICES FOR ADA RETROFITS

City of Costa Mesa

Costa Mesa P.D. - Shooting Range Upgrade (ADA)

Statement of Probable Cost

Date: 05/24/2021

Detail

DRAFT

Element	Quantity	Unit	Unit Cost	Total
07 Men's Lockers/Toilet				
Signage: Replace braille signage at wall. Relocate sign at door	575	sf	\$35.00	\$20,125.00
B18: Remove kick-down hold open	575	sf	\$12.00	\$6,900.00
B18: Adjust or replace door closer	575	sf	\$20.00	\$11,500.00
B18: Recess fire extinguisher (4" maximum protrusion)	1	ea	\$1,200.00	\$1,200.00
Signage: Relocate braille signage	1	ea	\$800.00	\$800.00
B16: Replace door signage	1	ea	\$250.00	\$250.00
Door to B16: Remove kick-down hold open	1	ea	\$300.00	\$300.00
Door to B16: Adjust or replace door closer	1	ea	\$900.00	\$900.00
Urinal: Relocate/replace paper towel combo	1	ea	\$400.00	\$400.00
Accessible toilet partition: replace partition door hardware with self-closing device	1	ea	\$3,000.00	\$3,000.00
Accessible toilet stall clearance: replace adjacent sink to provide 60" clear	1	ea	\$8,000.00	\$8,000.00
Accessible toilet stall: reconfigure partitions		ea	\$1,000.00	\$0.00
Accessible toilet stall: relocated/replace grab bars	1	ea	\$1,500.00	\$1,500.00
B17: Replace/relocate door signage	1	ea	\$800.00	\$800.00
Accessible shower: Relocate/replace/adjust seat	1	ea	\$2,000.00	\$2,000.00
Accessible shower: Relocate/replace/adjust water valve	1	ea	\$2,000.00	\$2,000.00
Accessible shower: Relocate/replace hand held spray unit	1	ea	\$4,000.00	\$4,000.00
Accessible shower: Floor Drain. Retile floor and reset floor drain	1	ea	\$2,000.00	\$2,000.00
B16: Sinks: insulate sink drains (completely)	1	ea	\$250.00	\$250.00
Sub-total				<u>\$65,925.00</u>

EXHIBIT C: SUPPLEMENTAL CONSTRUCTION ADMINISTRATION

October 19, 2021

Seung Yang, P.E.
City Engineer
City of Costa Mesa
77 Fair Dr. Costa Mesa CA 92626

Re: City of Costa Mesa Police Firing Range: Supplemental Construction Support Services

Seung,

This proposal would provide enhanced construction support services for renovation of City of Costa Mesa Police Firing Range including the additional scope for the ADA and accessibility retrofits to the existing facility.

A. PROJECT UNDERSTANDING
Supplemental Construction Administration and Support

The following additional architectural services to be provided during Construction:

- Attend weekly meetings during construction and assist City with formatting Weekly meeting minutes.
- Review and provide input on Contractor's construction schedule and status.
- Review and provide input on Contractor's order project updates for the project.
- Assist in coordination of Fire Safety Enhancements and Retrofits
- Assist City in reviewing coordination between the Contractor and City 's vendors (including telecommunications, audio visual, low voltage cabling, security, and furniture).
- Assist City in Construction Change Directives during construction.
- Assist City in reviewing of Contractor invoicing and credits with the city.
- Conduct field reviews to observe work by Contractor. Development of Field Reports as needed identifying observed work that is not consistent with the Construction Documents. (3 field reviews provided)
- Provide one follow-up visit after Punchlist to confirm that the noted construction deficiencies have been corrected or provide a summary of the deficiencies.

The scope of these services is based on the 80 working day construction schedule projected for this project.

B. COMPENSATION

We propose to furnish these services not to exceed the following fee:

Grand Total: \$32,000 (Thirty-Two Thousand Dollars)

Additional services outside the Scope of Work agreed upon shall not be performed without the authorization of the City. We have tailored our scope and subsequent fee proposal to accommodate the scope of work, realizing that there is latitude in both parameters to be discussed during the contract negotiation. We look forward to working with you on this project.

Sincerely,



Jack Panichapan, AIA, LEED AP
Principal, CEO,
Gillis + Panichapan Architects, Inc.