

PARTIDA, ANNA

PH-2

From: Jim Fitzpatrick <jimfitzeco@gmail.com>
Sent: Monday, April 24, 2023 10:58 AM
To: PC Public Comments
Cc: PARTIDA, ANNA; HALLIGAN, MICHELLE; Chris Glew
Subject: PA-22-02 1860 Newport Blvd - Support letters - Public Comments
Attachments: Support Letters - Newport Leaf - 1860 Newport Blvd 4.24.2023.pdf

Please make these Support Letters part of the public comments for this item

Please confirm they will be part of the public record and provided to Commissioners.

Cheers,

Jim Fitzpatrick

CAUTION: This email originated from outside of the organization. Do not click links or open attachments unless you recognize the sender and know the content is safe. Report any suspicious activities to the Information Technology Department.

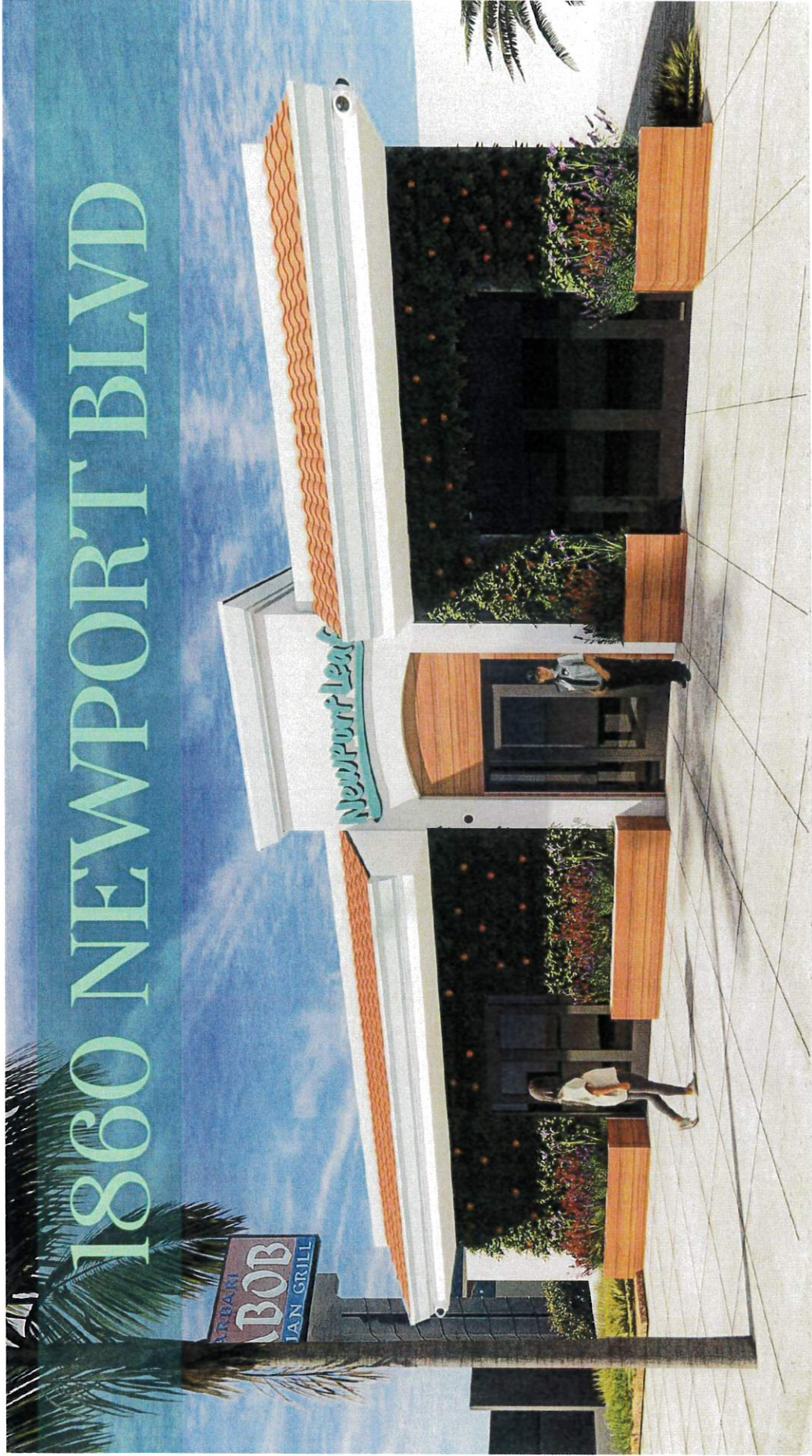

VICINITY SUPPORT

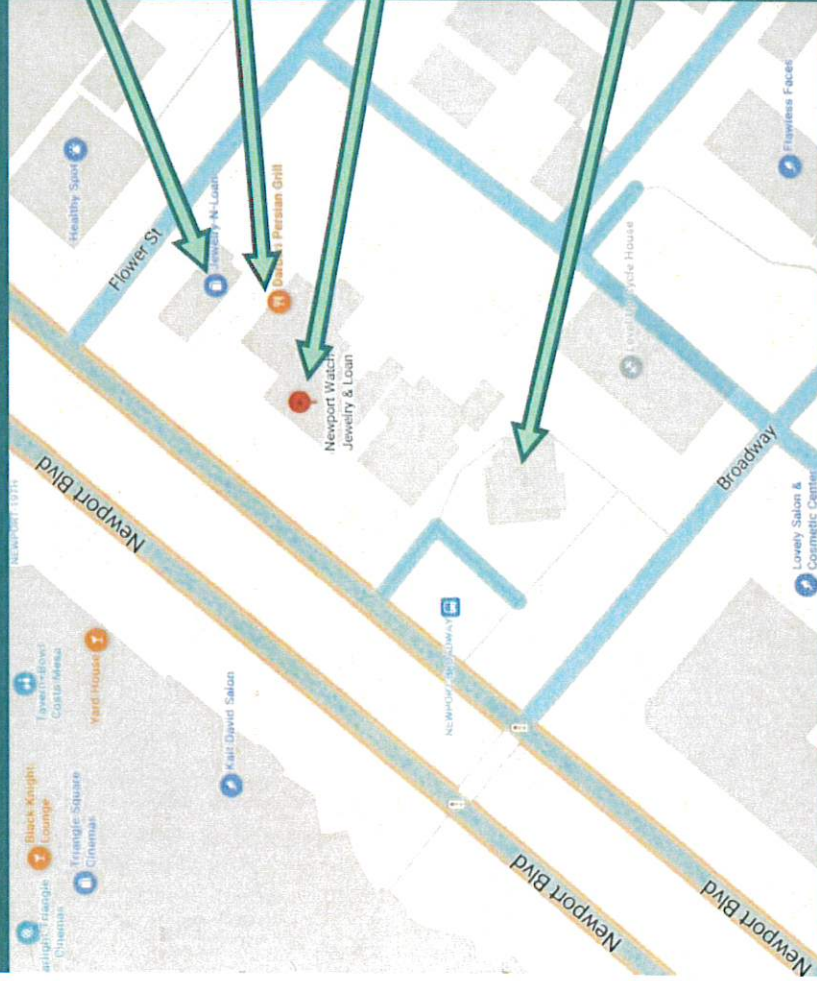



1860 Newport Blvd

Commissioners,

We have operated our successful business here on Newport Blvd for a long time.

Thank you to all who have patronized our store. We appreciate you.

By supporting this new Store, you will allow our business to move locations. We are voluntarily relocating our business from a larger store to a smaller store.

At one point in our history, we benefited from the foot traffic of Newport Blvd.

Now, we have an established customer base. Word of mouth is how we market.

We were approached by individuals seeking to locate a Cannabis Retail Store and thought this was a good time to downsize. We support this new business.

We understand the new business plan is to market to women as a women owned business and think it is a smart thing to do.

Many of our customers will be her customers. They know how to not only market to women, but to offer woman a safe and secure shopping experience with an elegant flair.

We will be keeping our business in Costa Mesa, just in a smaller store. Please let us know how we can be of service for all your watch and jewelry needs.

Please approve this Application.

Name: *Scott Mitchell*

Signature: 

Date: *4-5-23*

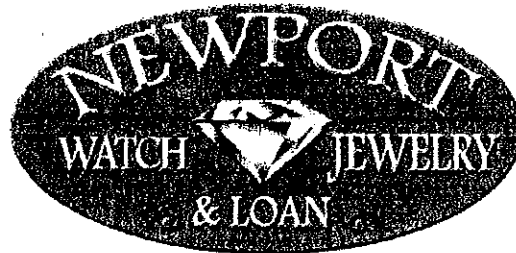

1860 Newport Blvd

Commissioners,

We have operated our successful business here on Newport Blvd for a long time.

Thank you to all who have patronized our store. We appreciate you.

By supporting this new Store, you will allow our business to move locations. We are voluntarily relocating our business from a larger store to a smaller store.

At one point in our history, we benefited from the foot traffic of Newport Blvd.

Now, we have an established customer base. Word of mouth is how we market.

We were approached by individuals seeking to locate a Cannabis Retail Store and thought this was a good time to downsize. We support this new business.

We understand the new business plan is to market to women as a women owned business and think it is a smart thing to do.

Many of our customers will be her customers. They know how to not only market to women, but to offer woman a safe and secure shopping experience with an elegant flair.

We will be keeping our business in Costa Mesa, just in a smaller store. Please let us know how we can be of service for all your watch and jewelry needs.

Please approve this Application.

Name: Jonathan Mitchem

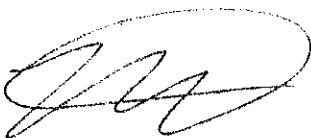
Signature: 

Date: 4-5-23

1854 Newport Blvd – PROPERTY OWNER

Planning Commissioners and City Staff,

I support this new business coming to my section of Newport Blvd.

This section of Newport Blvd will benefit from a 24 hour Security Guard and will be another business dedicated to working with other businesses.

I have known the Owner for several years. She is a wonderful person and demonstrates excellent leadership and business skills.

Her business plan to focus on women is a winner. This customer base will be great for all of our businesses and properties.

This team has my full support and I encourage the Planning Commission to approve their application.

Name: Michael Ng



Signature:



Date:

Newport Leaf – 1860 Newport Blvd - Support



April 14, 2023

Dear Planning Commissioners,

For the past seven years I have been at Jewelry-N-Loan on Newport Blvd. Begin with managing the location and then more recently purchasing the business.

I'm in support of the new cannabis retail store that has been proposed at 1860 Newport Blvd.. With meeting with the team that has put together the business plan I'm looking forward to the improvements they have discussed.

I'm happy to hear the 24 hour security guard and my approval for the permit has just one request. That during the night (dark) hours that there is a patrol of the block every thirty minutes. From Broadway to Flower St. and down the alley. Map shows request patrol area.

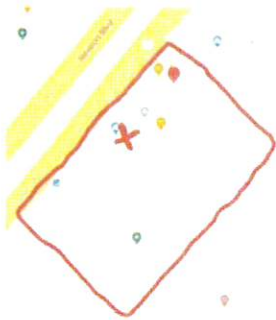

The fact this is a woman owned and woman focused business model allows me to get behind the plan even more. Having more people shop on the boulevard helps the city and the surrounding established business.

I'm in favor of approving their Conditional Use Permit and ask you to also approve the permit.

A handwritten signature in black ink, appearing to read "Steve Chandler".

Steve Chandler

YUMMI KARMA

HIGH
gorgeous

Support Letter - NEWPORT LEAF – 1860 Newport Blvd

April 24, 2023

Hello Commissioners,

I am Krystal Kitahara, Founder & CEO of Yummi Karma and the brand High Gorgeous.

We are one of the first Measure X operators in Costa Mesa.

It has not been an easy road, but I am happy to say that we are a successful woman owned, woman run brand that seeks to support women in general, and certainly women owned and woman run cannabis stores.

I believe Yummi Karma is the only woman run brand we know of.

It is exciting to support what we believe to be the first woman owned and woman run cannabis retail store. We look forward to this store getting open and we will look for many ways we can work together.

Even better that it is in Costa Mesa!

Thank you for supporting Cannabis in Costa Mesa.

I recommend you approve this Cannabis Retail Store Application.

Krystal Kitahara

Founder and CEO

Krystal Kitahara

Signed