



JEFFREY V. RIGGS, ARCHITECT, INC.

25 PECOS RANCHO SANTA MARGARITA, CA 92688
949 233 1533
E: jeffriggs09@gmail.com



TRENTA PIZZA & CUCINA
1661 SUPERIOR AVENUE, UNIT D
COSTA MESA, CA 92627

© JEFFREY V. RIGGS, ARCHITECT, INC.
JEFFREY V. RIGGS, ARCHITECT, INC. EXPRESSLY DISCLAIMS ANY AND ALL WARRANTIES, REPRESENTATIONS, AND OTHER PROPERTY RIGHTS IN THESE PLANS. THESE PLANS ARE NOT TO BE REPRODUCED, COPIED, OR OTHERWISE USED FOR ANY PURPOSES WITHOUT THE WRITTEN PERMISSION AND CONSENT OF JEFFREY V. RIGGS, ARCHITECT, INC. IN THE EVENT OF UNAUTHORIZED REUSE OF THESE PLANS BY A THIRD PARTY, THE THIRD PARTY SHALL HOLD JEFFREY V. RIGGS, ARCHITECT, INC. HARMLESS.

DO NOT SCALE PLANS

REVISIONS		
NO.	DATE	DESCRIPTION

PROJECT MANAGER:	JVR
DESIGNER:	JVR
DRAWN BY:	JVR
REVIEWED BY:	JVR
1ST BLDG. DEPT. SUBMITTAL:	
ISSUED FOR CONSTRUCTION:	
JOB NUMBER:	2019070
CAD FILE NAME:	ASP1.DWG

DATE:	10/22/21	SHEET:	ASP.1
-------	----------	--------	-------

1ST PLANNING DEPT. SUBMITTAL

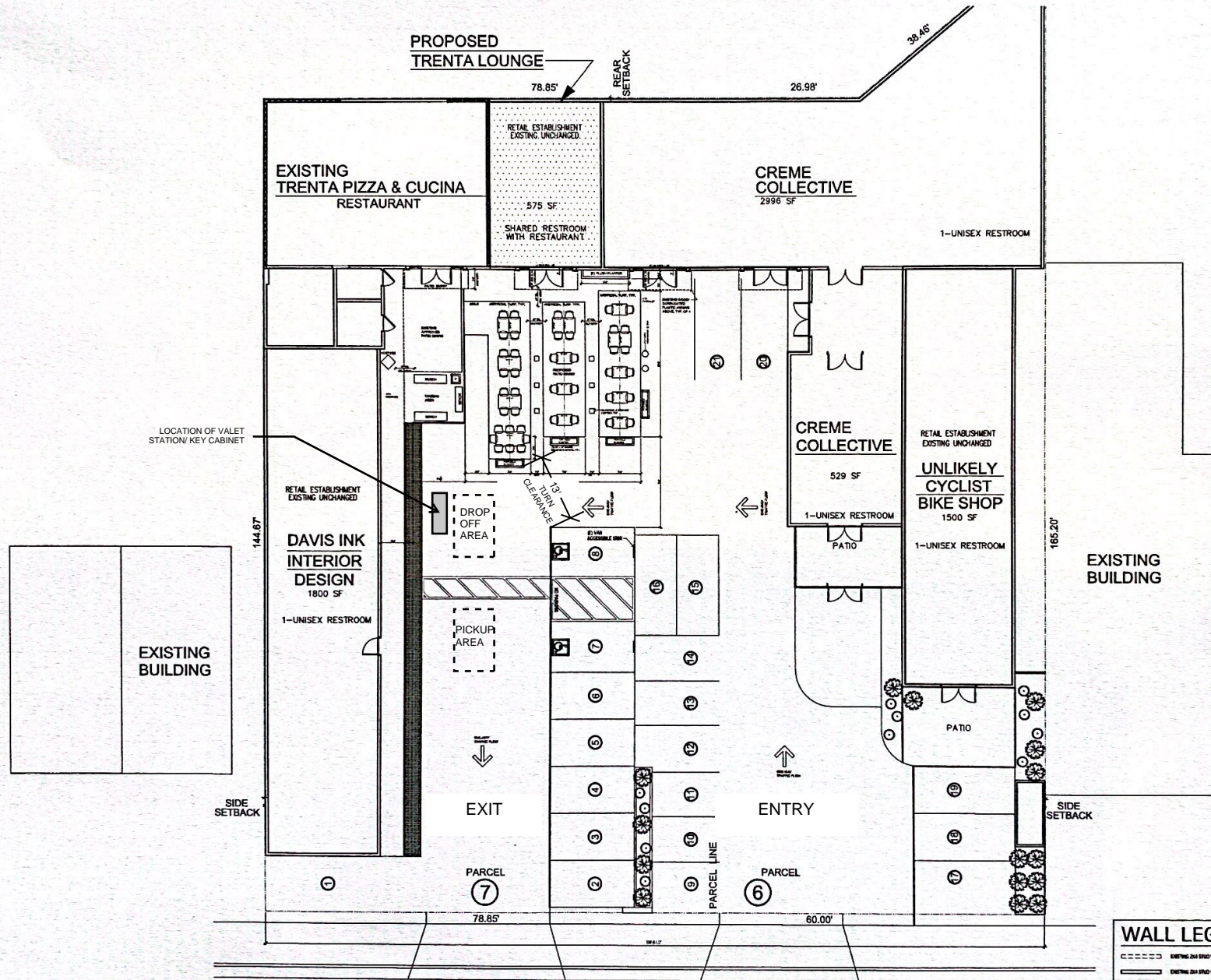

WALL LEGEND	
-----	EXISTING OR TO BE REMOVED
-----	EXISTING OR TO BE REMOVED

SCALE: 1/8" = 1'-0"

Alpha professional corp

7850 Slater ave spc 110
Huntington Beach, CA 92647
(714) 679 0028

Valet operation plan document

- Net increase in parking with valet implemented is 39 parking spaces
 - Loading area is located on the restaurant property west side of the parking lot. Valet is indicated with cones, signs and podium.
 - Unloading area is located on the restaurant property south of the parking lot and additional unloading area located at 1645 Superior ave Costa Mesa, CA, 92627.
 - Valet staffing is provided by Alpha Professional Corp.
 - Our team consists of three individuals for the weekdays and four for the weekend
-
- Luis A Espinoza
 - Neftali Torres Falafan
 - Luis Manuel Torres
 - Juan Perez
-
- Hours of operation
 - Monday – Sunday from 5:00pm – 10:00pm

